

**oerthli**<sup>®</sup>  
SWITZERLAND

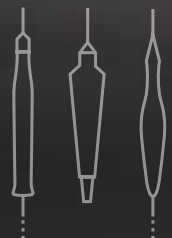

**ACCESSORIES**  
MAKING THE DIFFERENCE  
WITH UNIQUE INSTRUMENTS

EYE SURGERY. SWISS MADE.





# MAKING THE DIFFERENCE WITH SAFETY AND SIMPLICITY

«Until now I have strong confidence in the Oertli phaco machine regarding the power, holding strength and anterior chamber stability. The six-piezzo phaco handpiece remains cold throughout the procedure. This machine is portable, lightweight and versatile for use in mass eye-camp cataract surgery and performs well at any site.»

**Dr. Vidyapati Mangunkusumo**  
Jakarta Eye Center  
Menteng, Kedoya, Jakarta, Indonesia

# SUPERBLY STRUCTURED EYE SURGERY

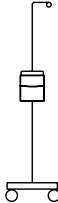
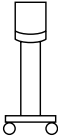
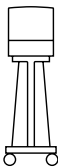
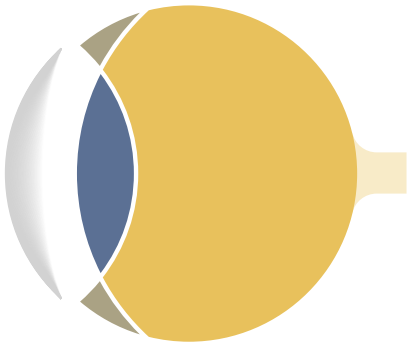

	OS4™	Faros™	CataRhex 3®
Cataract	●	●	●
Glaucoma	●	●	●
Vitreotomy	●	●	

As a basic principle, all instruments are compatible with all Oertli surgical platforms, provided the relevant function is available. Some instruments require a certain function as a prerequisite, for these instruments the matching platforms have been indicated with the symbols in the margin.



# PERFECTION TO THE CORE

With its innovative developments and first-class quality, Oertli has set new standards in cataract surgery, vitrectomy and glaucoma surgery over and over again. Oertli surgical platforms, technologies and instruments enable surgeons and OR personnel to perform surgeries in a safer, easier and more efficient way – thus achieving better results for patients.

To ensure perfect processes and results, Oertli surgical platforms form a closed system together with their matching instruments. Every instrument is compatible with every Oertli surgical platform, provided the relevant function is available.

With its instruments, hand pieces, tips and auxiliary means, Oertli has consistently built on quality. Instruments are developed in Berneck, Switzerland and perfected with the highest degree of precision to make surgeons fully rely on their tools.



Christoph Bosshard  
CEO

Thomas Bosshard  
Head of Marketing & Sales

## Device accessories

Surgical platforms	OS 4	6
	Faros	8
	CataRhex 3	10

## Instruments

### Cataract

Capsulorhexis	<b>HF capsulotomy</b>	<b>12</b>
	Diathermy hand piece, reusable	14
	Capsulotomy tip, reusable	14
Phaco	<b>easyPhaco technology</b>	<b>16</b>
	Phaco hand piece, reusable	17
	easyTips, single use	18
	easyTips, reusable	19
	Various phaco accessories, single use & reusable	20
Irrigation / Aspiration	<b>Quick tips with safety design</b>	<b>22</b>
	I/A hand piece bimanual, single use & reusable	23
	I/A hand piece coaxial, reusable	24
	I/A Quick tips coaxial, reusable	25
	Irrigation sleeve for Quick tips, reusable	26
Diathermy	Diathermy hand piece, reusable	28
	Diathermy tip & forceps, reusable	28
Anterior vitrectomy	Classic pneumatic vitrectomy cutter, single use & reusable	29
<b>Glaucoma</b>	<b>HFDS ab interno MIGS technology</b>	<b>31</b>
	Diathermy hand piece, reusable	32
	HFDS glaucoma tip, reusable	32

### Posterior vitrectomy

Access	<b>Caliburn trocar system</b>	<b>34</b>
	Caliburn trocar system, single use	35
	Infusion terminal, single use	36
Intra-ocular illumination	<b>25G Chandelier illumination</b>	<b>37</b>
	Endo illuminator, single use	38
Vitreous body removal	<b>Continuous Flow Cutter</b>	<b>39</b>
	Continuous Flow Cutter, single use	40
Peeling	<b>Membrane FEELceps</b>	<b>41</b>
	Membrane FEELceps, single use	42
Injection/Extraction	Air delivery line & silicone application set, single use	44
Laser	<b>Laser probes</b>	<b>46</b>
	Laser probes	47
	Laser accessories	48
Diathermy	Diathermy hand piece, reusable	49
	Endo diathermy tips, reusable	50
Vitrectomy accessories	Various vitrectomy accessories, reusable	50

## Consumables

OS 4	51
Faros/CataRhex 3	52

# MAKING THE DIFFERENCE WITH ENHANCED VERSATILITY

## OS4™



### **Eye surgery of the highest level**

- Three-pump system with vacuum and flow control
- SLEEPMode for very precise manoeuvres
- Double light-source with colour adjustable LED technology
- Continuous Flow Cutter for traction-free vitreous body removal
- Fully integrated 532 nm endo laser
- Wireless, dual linear pedal for all functions

**Pedal, dual-linear**

The wireless, dual-linear pedal – the sensitive control unit of the OS 4 – boasts individually programmable auxiliary buttons and a battery runtime of up to 50 hours.

VE860010

---



**Instrument tray 80 × 35 cm**

The optional instrument tray can be fixed at any desired position. If not needed, the tray can quickly and easily be folded in sideways.

VE860001

---



**Protective cover**

So that the OS 4 is reliably protected from dirt and dust when it is not being used.

VE860030

---



# MAKING THE DIFFERENCE WITH LEADING INNOVATION

**Faros™**

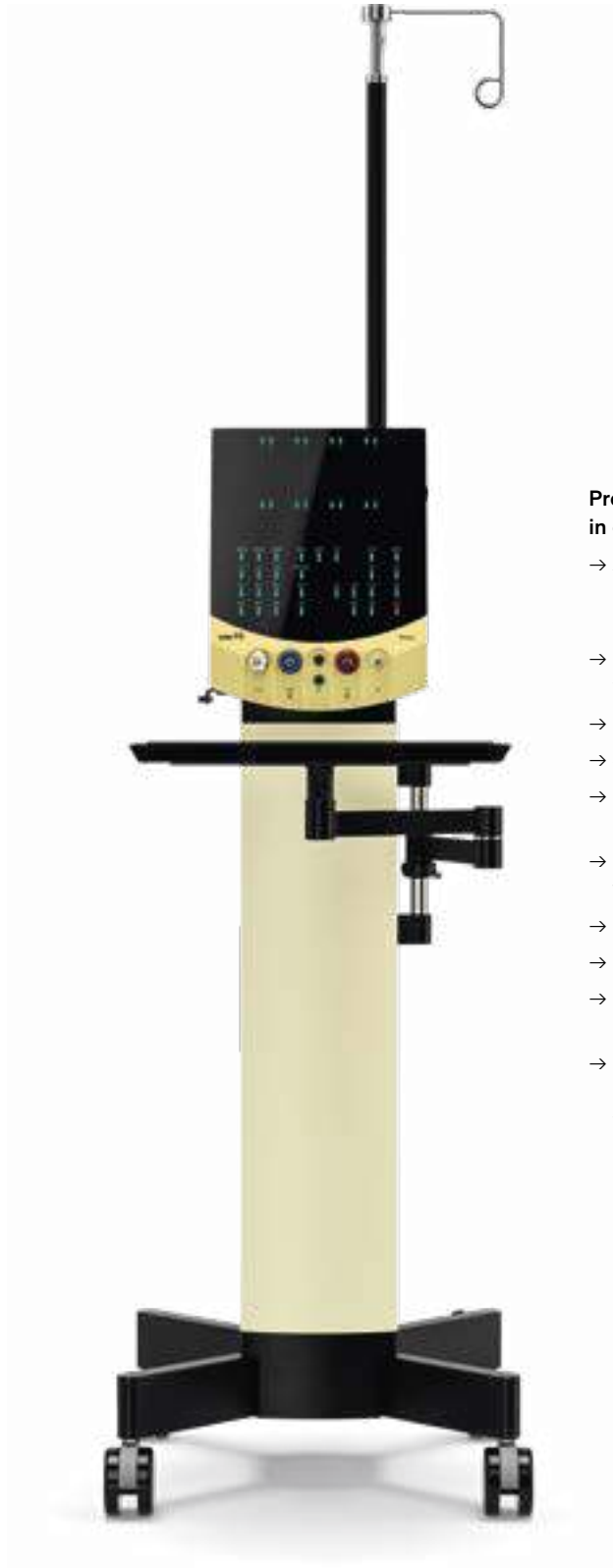

## **Precision and efficiency in eye surgery**

- Available as an anterior platform or as a combined anterior/posterior platform
- Cutting-edge dual-pump system with flow and vacuum control
- Unique SPEEPMode
- Superb capsulotomy function
- Integrated HFDS application for glaucoma surgery
- Continuous Flow Cutter for traction-free vitreous body removal
- Modern LED technology
- Dual linear foot pedal
- Ready for operation within seven seconds
- Integrated air compressor for autonomous work in anterior vitrectomy





**Pedal, dual-linear**

The compact multifunctional pedal (22 × 30 cm) holds safely in position and can nevertheless be moved easily with the foot stirrup.

VE830011

---

**Instrument tray 28 × 30 cm**

The optional instrument tray can be individually positioned and fixed. If not needed, it can easily be folded sideways.

VE840002

---



**Remote control, wireless**

If required, faros control can also be performed via the pleasantly tangible command keys of the wireless remote control.

VE840020

---

**Protective cover**

Thanks to the robust plastic cover, the faros is well protected from dirt and dust when it is not being used.

VE840030

---

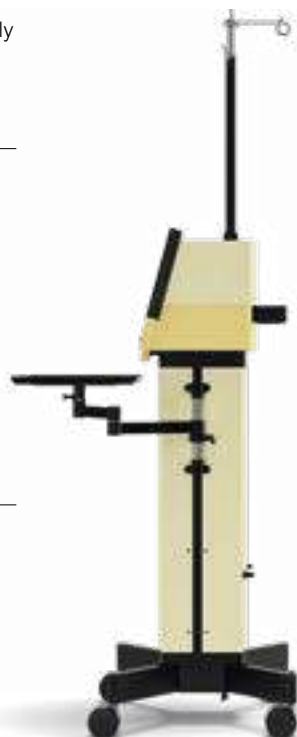

# MAKING THE DIFFERENCE WITH MAXIMUM MOBILITY

## CataRhex 3®



### Flexibility without making a compromise in performance

- Safe and efficient emulsification thanks to easyPhaco
- Easy capsulorhexis with HF capsulotomy tip
- CortexMode in I/A for greater safety
- Integrated compressor for anterior vitrectomy
- HFDS application for glaucoma surgery
- Precise flow control

### Pedal, linear

Robust multifunctional pedal for precise control of the system. Waterproof, requiring very little space, and weighing only 2.6 kg.

VE821015





**Sterile touch**

For contamination-free actuation of keys.

VE850003

---



**Carrying case**

Perfectly dimensioned case for transporting the CataRhex 3. With separate compartments for pedal, pads and instruments. Made of robust leather, with combination lock.

VE820003

---



**Infusion trolley**

The optional infusion trolley makes the CataRhex 3 a flexible surgical platform.

VE820001

---



**Instrument tray**

attachable to infusion trolley VE820001.

Handy, solid and easy to install.

VE820002

---



# HF CAPSULOTOMY

## HF capsulotomy ensures comfort and safety – even in difficult cases

Founded in 1991, HF capsulotomy has proven itself in innumerable surgeries as an especially gentle alternative to capsulorhexis. HF capsulotomy melts the capsule bag; there is no tearing with forceps or needles, only a gentle sliding over tissues and even under the iris. The capsule edge that is created meets the highest requirements – in terms of intra-operative and long-time success.

## Not only in terms of safely correcting a rhexis out of control but also:

- No fundus reflex

---

- Hypermature, traumatic and intumescent cataract

---

- Narrow pupil

---

- Rhexis phimosis

---

- Juvenile cataract

---

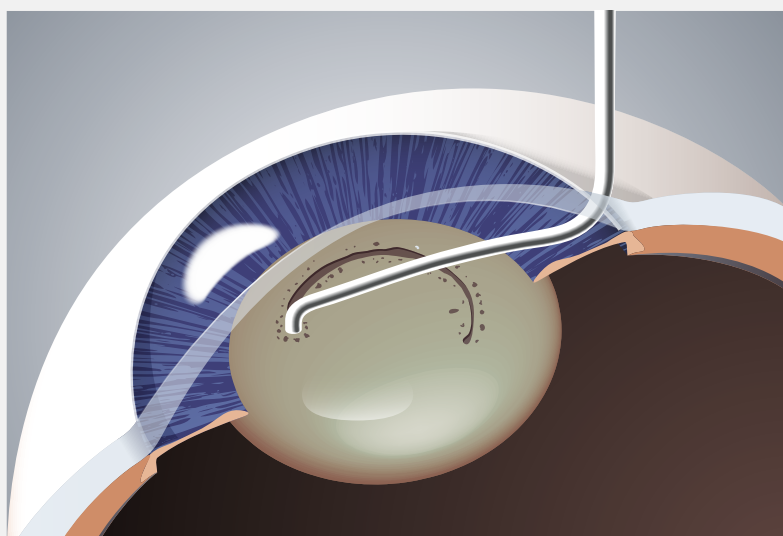
# CAPSULOTOMY





## Diathermy hand piece, reusable

---

**Handpiece short**, plug-on, diathermy, cable 3 m,  
floating connector  
VE201712

---

**Handpiece long**, plug-on, diathermy, cable 3 m,  
floating connector  
VE201710

---



## Capsulotomy tips, reusable

---

**Capsulotomy plug-on tip standard**  
VE201726

---

**Capsulotomy plug-on tip long,**  
0.5 mm, capsular fimosi  
VE201730

---

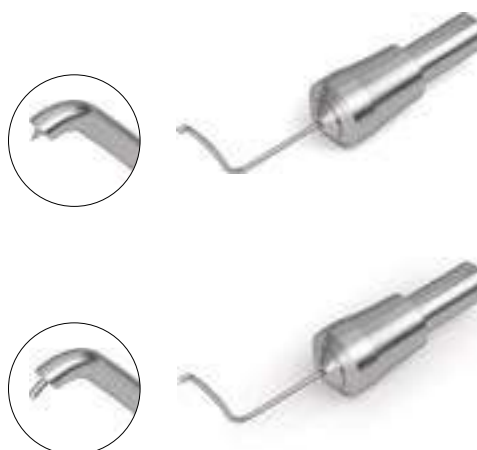

# CATARACT



# PHACO

## easyPhaco® technology

Thanks to Oertli's clever needle design, its sophisticated fluidics concept and world class pump systems, easyPhaco technology offers visible and tangible benefits:

- Unprecedented chamber stability, perfect emulsification and extremely effective aspiration of fragments
- Gentle and effective aspiration resulting in excellent followability and holdability of fragments
- Concentrated axial ultrasound and highest possible power generation for perfect emulsification
- Elimination of vacuum fluctuations thanks to a capillary aspiration path

Oertli easyPhaco technology is available in three different tip sizes. All incisions are covered irrespectively of whether you work with sub 2 mm coaxial micro phaco or with standard incision sizes up to 3.2 mm.

### Recommended settings for easyPhaco

		Minimum			
		Venturi pump		Peristaltic pump/SPEEPMode	
		Vacuum (mmHg)	Vakuum effect (%)	Flow (ml/min)	Vacuum (mmHg)
easyTip CO-MICS for incisions of 1.6–1.8 mm	Phaco 1 (grooving)	80	60	18	50
	Phaco 2	250	60	20	250
easyTip 2.2 mm for incisions of 2.2–2.4 mm	Phaco 1 (grooving)	80	60	18	50
	Phaco 2	400	60	40	400
easyTip 2.8 mm for incisions of 2.8–3.2 mm	Phaco 1 (grooving)	80	60	18	50
	Phaco 2	400	60	40	400

		Maximum			
		Venturi pump		Peristaltic pump/SPEEPMode	
		Vacuum (mmHg)	Vakuum effect (%)	Flow (ml/min)	Vacuum (mmHg)
easyTip CO-MICS for incisions of 1.6–1.8 mm	Phaco 1 (grooving)	100	80	18	50
	Phaco 2	350	100	28	350
easyTip 2.2 mm for incisions of 2.2–2.4 mm	Phaco 1 (grooving)	100	80	18	50
	Phaco 2	500	100	50	500
easyTip 2.8 mm for incisions of 2.8–3.2 mm	Phaco 1 (grooving)	100	80	18	50
	Phaco 2	500	100	50	500

- Recommended height of bottle: 100 cm above patient's eye
- Recommended additional settings: Pulse mode, 40Hz, 60% cooling for phaco 2.

easyPhaco is a development by Oertli R&D in scientific collaboration with Prof. Rupert Menapace, Vienna.



## Phaco hand piece

---



### **Phaco hand piece, reusable**

Having an outside diameter of 13 mm, an internal infusion tube, being extremely light weight (42 grams) and completely made of titanium, the Oertli phaco hand piece has set the standards since 2002. The hand piece, which is equipped with 6 piezo crystals, is ideally suited for easyPhaco technology and MICS. The three-meter-long highly flexible cable and the fantastic grip increase user comfort and safety even further. Due to its distinct manufacturing quality, the phaco handpiece is incredibly robust and durable.

ONLY  
42  
GRAM



**U/S phaco hand piece** with cable 3 m  
VG800011

---



## easyTips, single use

Titanium easyTip, single use

Sterile/single use, box of 10, including easyTip, irrigation sleeve, test chamber, phaco key and emergency key

**Titanium easyTip, CO-MICS, 30°**

for incisions of 1.6–1.8 mm

VV806833A



**Titanium easyTip, CO-MICS, 53°**

for incisions of 1.6–1.8 mm

VV806833



**Titanium easyTip, 2.2 mm, 15°**

for incisions of 2.2–2.4 mm

VV806835B



**Titanium easyTip, 2.2 mm, 30°**

for incisions of 2.2–2.4 mm

VV806835A



**Titanium easyTip, 2.2 mm, 40°**

for incisions of 2.2–2.4 mm

VV806835



**Titanium easyTip, 2.8 mm, 30°**

for incisions of 2.8–3.2 mm

VV806840



## easyTips, reusable



---

### Titanium easyTip, CO-MICS, 30°

for incisions of 1.6–1.8 mm

VV800831



---

### Titanium easyTip, CO-MICS, 53°

for incisions of 1.6–1.8 mm

VV800833



---

### Irrigation sleeve for easyTip, CO-MICS

silicone, grey

VV603231



---

### Titanium easyTip, 2.2 mm, 15°

for incisions of 2.2–2.4 mm

VV800735B



---

### Titanium easyTip, 2.2 mm, 30°

for incisions of 2.2–2.4 mm

VV800735A



---

### Titanium easyTip, 2.2 mm, 40°

for incisions of 2.2–2.4 mm

VV800735



---

### Irrigation sleeve for easyTip, 2.2 mm

silicone, transparent

VV603220



---

### Titanium easyTip, 2.8 mm, 30°

for incisions of 2.8–3.2 mm

VV800740



---

### Irrigation sleeve for easyTip, 2.8 mm

silicone, blue

VV603209





## Various phaco accessories, reusable

---

### Key for phaco tips with titanium insert

VE800100

---



### Test chamber for phaco, silicone

VV803100

---



### Protection cap for phaco handpiece, titanium

VV803200

---



## Various phaco accessories, single use

---

### Active infusion set

Sterile/single use, box of 6  
VV662006

---



# IRRIGATION / ASPIRATION



# QUICK TIPS WITH SAFETY DESIGN

## I/A instruments for fast and safe interventions

The Quick Tips with Safety Design have an extended shaft length to enable better sub-incisional access. The downsized aspiration opening enables better occlusion, increases safety during aspiration and ensures optimum stability of the anterior chamber. The cleverly thought-out positioning of the aspiration opening prevents unintended gripping of the capsule bag. Especially in a combined application with SPEEPMoDe (OS 4) and CortexMoDe (CataRhex3), the Quick Tips ensure the highest degree of safety.

### Features and benefits

- Absolutely stable anterior chamber
- Easy sub-incisional accessibility
- Occlusion achieved quickly
- High safety standard during capsule cleaning
- Highly efficient in combination with SPEEPMoDe / CortexMoDe



In addition, the tips have a clever Quick Tip snap lock, which enables fast changing of tips in the sterile field.

The I/A Quick Tips with Safety Design are intended for use with an irrigation sleeve.

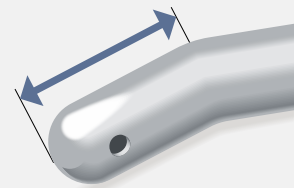

**Extended shaft length** to enable better sub-incisional access.

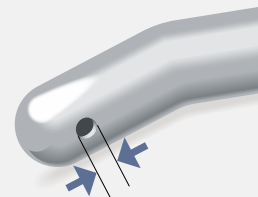

**Downsizing of the aspiration opening** has resulted in a better occlusion capacity, increased safety during aspiration and greater stability of the anterior chamber.

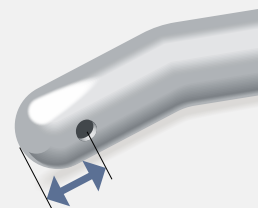

**The new position of the aspiration opening** prevents from unintentionally gripping the capsule bag.

## I/A hand piece bimanual, single use



Sterile/single use, box of 10

**I/A bimanual instruments set,**  
aspiration opening 0.30 mm,  
irrigation opening 0.50 mm,  
diameter 0.80 mm  
VV650010



## I/A hand piece bimanual, reusable



**I/A bimanual instrument kit**  
aspiration opening 0.30 mm,  
irrigation opening 0.50 mm,  
diameter 0.80 mm  
VE654100

**I/A bimanual instrument kit**  
roughened tips  
aspiration opening 0.30 mm,  
irrigation opening 0.50 mm,  
diameter 0.80 mm  
VE654101



**I/A bimanual instrument kit**  
aspiration opening 0.30 mm,  
irrigation opening 0.45 mm,  
diameter 0.62 mm  
VE654103

● 23G



## I/A hand piece coaxial, reusable

---

### I/A Handpiece Quick Tip, titanium

VE655000

---



### Irrigations hand piece titanium with Luer connection

VE603010

---



### Luer adaptor Quick Tip, female

VE655020

---





## I/A Quick tip system coaxial, reusable



---

### Quick Tip for I/A with irrigation sleeve, 45°

aspiration opening 0.25 mm, leg length 1.2 mm,  
for incisions of 1.6–1.8 mm, SAFETY DESIGN

VE655527

---



### Quick Tip for I/A with irrigation sleeve, 45°

aspiration opening 0.25 mm, leg length 1.5 mm  
for incisions of 2.2–3.2 mm, SAFETY DESIGN

VE655525

---



### Quick Tip for I/A with irrigation sleeve, 45°

aspiration opening 0.25 mm, leg length 2.1 mm  
for incisions of 2.2–3.2 mm, SAFETY DESIGN

VE655526

---



### Quick Tip for I/A with irrigation sleeve, 45°

aspiration opening 0.35 mm, leg length 1.5 mm  
for incisions of 2.2–3.2 mm

VE655535

---



### Quick Tip for I/A with irrigation sleeve, straight

aspiration opening 0.35 mm,  
for incisions of 2.2 bis 3.2 mm

VE655035

---



### Quick tip for I/A, sleeveless, 45°

aspiration opening 0.35 mm, leg length 1.5 mm  
for incisions of 2.8–3.2 mm, diameter 1.8 mm

VE655235

---





## Irrigation sleeve for easyTips, reusable

---

**Irrigation sleeve for easyTip CO-MICS,**  
Silikon, grey  
VV603231

---



for VE655527

---

**Irrigation sleeve for easyTip 2.2 mm,**  
Silikon, transparent  
VV603220

---



for VE655035  
VE655525  
VE655526  
VE655535

---

**Irrigation sleeve for easyTip 2.8 mm,**  
Silikon, blue  
VV603209

---



for VE655035  
VE655525  
VE655526  
VE655535

---

# DIATHERMY





## Diathermy hand piece, reusable

---

**Hand piece short**, plug-on, diathermy,  
cable 3 m, floating connector  
VE201712

---

**Hand piece long**, plug-on, diathermy,  
cable 3 m, floating connector  
VE201710

---



## Diathermy tip, reusable

---

**Diathermy plug-on tip «Eraser»**, 1.1 mm, 25 mm, 50° bevel  
VE201722

---

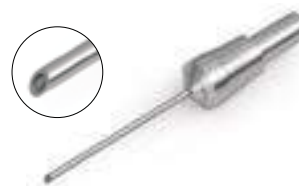

## Diathermy forceps, reusable

---

**Bipolar forceps** plug-on curved  
VE203902

---



## Classic pneumatic vitrectomy cutter, single use



Sterile/single use, box of 10

---

**SPS vitrectomy cutter**

⊗ ● 20 G

VV104010

---

**SPS vitrectomy cutter**

⊗ ● 23 G

VV106010

---

**SPS vitrectomy cutter**

⊗ ● 25 G

VV105010

---

**Irrigation sleeve for SPS**

● 20 G

1,5 mm diameter, with tube and Luer adapter

VG601351

---



# HFDS® GLAUCOMA PROCEDURE



# HFDS™ AB INTERNO MIGS TECHNOLOGY

## High frequency diathermy resulting in long-term pressure decrease

High Frequency Deep Sclerotomy (HFDS) glaucoma surgery is a new ab interno procedure to lower the intraocular pressure in open-angle glaucoma. Using high frequency energy, six small pockets are formed in the iridocorneal angle, which significantly reduce the outflow resistance for aqueous humour.

### Features and benefits

- Ideal in combination with cataract surgery or as individual application
- Very short intervention time
- Excellent long-term results
- No bleb-formation, no corneal scars
- Surgery can be repeated if necessary
- Very low complication rate



Area of application



Positioning of abee tip



Forming of sclerotomy pockets



### Excellent long time results (72 months) after performed HFDS procedure\*

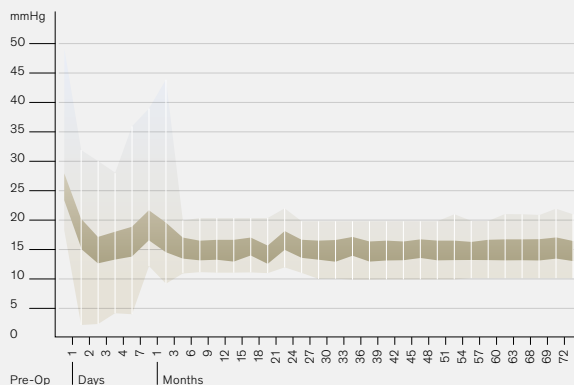

\*Bojan Pajic: Long-term Results of a Novel Minimally Invasive High Frequency Deep Sclerotomy Ab Interno Surgical Procedure for Glaucoma, European Ophthalmic Review, Volume 6, Issue 1, Spring 2012, ISSN 1756-1795



abee Glaucoma tip

### Literature

- Pallas G, Pajic B. 1999: Die Sklerathalamektomie (STE): Stabile postoperative Augendruckregulierung beim Offenwinkel- und Kapselhäutchenglaukom. Klein Monatsbl. Augenheilk. 2000; 216: 256-260
- Pajic B, Pallas G, Gerding H, Böhnke M.: A novel technique of ab interno glaucoma surgery: follow-up results after 24 months. Graefes Arch Clin Exp Ophthalmol 2005 Jul; 19: 1-6
- Pajic B.: High-Frequency Deep Sclerotomy, Cataract & Refractive Surgery Today, October 2011



## Diathermy hand piece, reusable

---

**Handpiece short**, plug-on, diathermy,  
cable 3 m, floating connector  
VE201712

---

**Handpiece long**, plug-on, diathermy,  
cable 3 m, floating connector  
VE201710

---



## HFDS™ glaucoma tip, reusable

---

**abee glaucoma tip**, ab interno  
High Frequency Deep Sclerotomy (HFDS)  
VE201751

---





# POSTERIOR VITRECTOMY



# CALIBURN™ TROCAR SYSTEM

«The lancet-pointed needle from Oertli had remarkable low piercing and cutting forces.»

Source: Geometry, penetration force, and cutting profile of different 23-gauge trocars systems for pars plana vitrectomy, C.H. Meyer MD, H. Kaymak MD, published in the November 2014 issue of the Retina Journal (Volume: 34:2290–2299, 2014).

## Working with the sharpest instruments

- Incision template for exact trocar placement
- Easy finding and entry with instruments
- Unique surface finish for even smoother incisions
- Less resistance on trocar edge-entry
- Patented integrated, double-slotted sealing membrane
- Patented snap-on lock infusion line for more flexibility
- Reliably constant IOP during surgery
- Reliable retention of the trocar
- Superb post-operative wound tightness
- Color coded for each gauge size

## Caliburn™ trocar system, single use



Sterile/single use, box of 10

**Caliburn trocar system,**  
one step, autoseal  
VV123311

⊗ ● 23 G



**Caliburn trocar system,**  
one step, autoseal  
VV125311

⊗ ● 25 G



**Caliburn trocar system,**  
one step, autoseal  
VV127311

⊗ ● 27 G





## Caliburn™ trocar system, single use

---

Sterile/single use, box of 10

**Infusion line 6 mm for Caliburn trocar system, autoseal**  
VV123211

---

⊗ ● 23 G

**Infusion trocar with infusion line  
and mandrel for Caliburn trocar system**  
VV123212

---

⊗ ● 23 G

**Incision template for Caliburn trocar system**  
Sterile/single use, box of 100  
VV125110

---

⊗



## Infusion terminal, single use

---

Sterile/single use, box of 10

**Infusion terminal 4 mm, silicone 6000CS**  
VV690221

---

⊗ ● 20 G

**Infusion terminal 6 mm, silicone 6000CS**  
VV690231

---

⊗ ● 20 G



# 25 G CHANDELIER ILLUMINATION



## Enlightening bimanual surgery light

→ Extrawide and homogeneous illumination

→ Accurate positioning with bendable loop  
of the fiber

→ Reliable snap-lock into all Oertli Caliburn trocars

→ Compatible to Oertli Caliburn 23 G and 25 G  
trocars

→ Precise and comfortable connector to Oertli  
surgery platforms

→ Postoperative tight incision





## Endo illuminator, single use

Sterile/single use, box of 10

**Endo illuminator 90°**, comfort-connector  
VV300101

⊗ ● 20G



**Endo illuminator 90°**, comfort-connector  
VV300103

⊗ ● 23G



**Endo illuminator 90°**, comfort-connector  
VV300105

⊗ ● 25G



**Endo illuminator Panorama**,  
shielded, comfort-connector  
VV300191

⊗ ● 20G



**Endo illuminator Panorama**,  
shielded, comfort-connector  
VV300194

⊗ ● 23G



**Lichtstab Panorama**,  
shielded, comfort-connector  
VV300195

⊗ ● 25G



**Chandelier illuminator with trocar**,  
for 23G and 25G, comfort-connector  
VV300152

⊗ ● 25G



# CONTINUOUS FLOW CUTTER

«This cutter is very efficient and effective. I have got an outstanding control for peripheral vitreous removal.»

Early user, Italy



## A new level of vitrectomy cutter

→ 100% continuous flow for tear-free high speed cutting

→ Perfect portioning of vitreous body removal

→ Highest efficiency and safety in core vitrectomy

→ Excellent precision for all maneuvers

→ Ability to peel and manipulate membranes

→ Continuous holding force

→ Absolute minimal distance of cutter port from the distal end

→ Double cut-rate

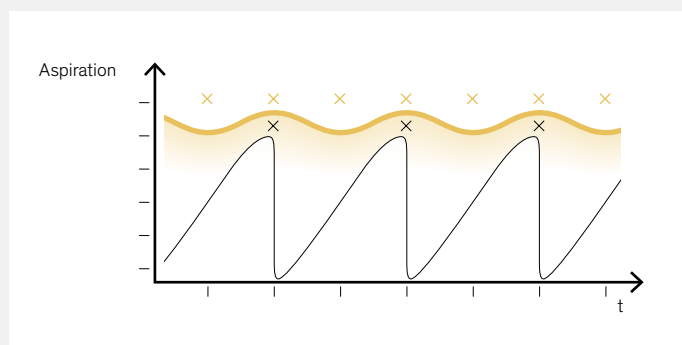

- × Cut
- Oertli Continuous Flow Cutter: continuous flow without any noticeable fluctuations. With each cycle, vitreous body is removed twice.
- Standard Cutter: Flow is interrupted with each cycle.



## Continuous Flow Cutter, single use

Sterile/single use, box of 10

**Continuous Flow Cutter**  
VV104110

⊗ ● 20 G



**Continuous Flow Cutter**  
VV106110

⊗ ● 23 G



**Continuous Flow Cutter**  
VV105110

⊗ ● 25 G



**Continuous Flow Cutter**  
VV107110

⊗ ● 27 G



## Classic pneumatic vitrectomy cutter, single use

Sterile/single use, box of 10

**SPS vitrectomy cutter**  
VV104010

⊗ ● 20 G

**SPS vitrectomy cutter**  
VV106010

⊗ ● 23 G

**SPS vitrectomy cutter**  
VV105010

⊗ ● 25 G





# MEMBRANE FEELceps™



## Feel the precision, feel the grip

- Minimal activation force

---

- Strong holding force of tissue

---

- Anti-shredding finish

---

- Short, absolutely linear stroke

---

- Great responsiveness

---

- Precise 360° actuation

---

Working with forceps on the retina is a very delicate matter. Surgeons need to have great intuition and precision to work with such small instruments in the posterior eye segment.

Therefore, extraordinary forceps are Oertli's solution to meet such requirements. Using the FEELceps – a name derived from feel and forceps – surgeons can actually feel every manoeuvre directly at their fingertips – a well controllable instrument delivers better results for surgeons and patients alike.



## Membrane FEELceps™, single use

Sterile/single use, box of 10

**Membrane FEELceps**, symmetrical

VV200013

⊗ ● 23 G

**Membrane FEELceps**, symmetrical

VV200015

⊗ ● 25 G



**Membrane FEELceps**, asymmetrical

VV200023

⊗ ● 23 G

**Membrane FEELceps**, asymmetrical

VV200025

⊗ ● 25 G



# VITRECTOMY ACCESSORIES



## Various vitrectomy accessories, single use

---

Sterile/single use, box of 10



### Air delivery line with filter

VV690100

---



### Air delivery line with filter

VV690101

---



### Silicone application set 20 cc, visco system

VV690310

---



# LASER PROBES



# LASER PROBES

## Precisely controlled laser application

- 0 to 90° bending angle of the tip –outstanding reach to the peripheral retina

---

- Ergonomic handle with 360° actuation

---

- Control of the bending at the surgeon's fingertips – allowing to position different spots of laser with gentle surgeon control

---

- Naturally straight – therefore safe to remove without having to retract the curved fiber

---

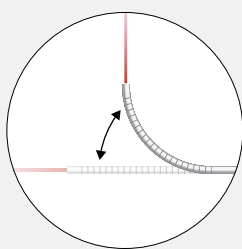
Stageless and  
precisely steerable  
laser tip



## Laser probes, single use



Sterile/single use, box of 10

**Laser probe, steerable**

VK400123

⊗ ● 23 G

**Laser probe, steerable**

VK400125

⊗ ● 25 G

**Laser probe, straight**

VK400101

⊗ ● 20 G

**Laser probe, straight**

VK400103

⊗ ● 23 G

**Laser probe, straight**

VK400105

⊗ ● 25 G

**Laser probe, straight**

VK400107

⊗ ● 27 G

**Laser probe, curved**

VK400111

⊗ ● 20 G

**Laser probe, flexible curved**

VK400113

⊗ ● 23 G

**Laser probe, flexible curved**

VK400115

⊗ ● 25 G

**Laser probe, flexible curved**

VK400117

⊗ ● 27 G





## Laser accessories, reusable

---

### Laser protection glasses

Filter impact OD6+, blocked wavelength 532 nm  
F18.P1 E01.1001 MED

---



### User protection filter Zeiss/HS Moeller Microscope

340833

---

### User protection filter Leica Microscope

340846

---

### User protection filter Topcon Microscope

340990

---





## Diathermy hand piece, reusable

---



**Handpiece short**, plug-on, diathermy,  
cable 3 m, floating connector  
VE201712

---

**Handpiece long**, plug-on, diathermy,  
cable 3 m, floating connector  
VE201710

---



## Endo diathermy tips, reusable



**Endo diathermy plug-on tip, 28 mm, 54° pointed**

● 20 G

VE201723

**Endo diathermy plug-on tip, 28 mm, 54° pointed**

● 23 G

VE201733

**Endo diathermy plug-on tip, 28 mm, 54° pointed**

● 25 G

VE201732

**Endo diathermy plug-on tip, 28 mm,  
54° pointed, tapered 0.45 mm**

● 20 G

VE201724



## Various vitrectomy accessories, reusable

**Titanium tip, phaco,**  
for Pars Plana vitrectomy  
VV800051

● 20 G



# CONSUMABLES

OS 4™



---

## I/A cassette

including giving set and display cover bag

Sterile/single use, box of 10  
VV660010

---



---

## Drainage bag for cassettes and tubing sets

Single use, box of 20  
VV636010

---



---

## Example phaco OR pack OS 4

Cassette, easyTip 2.2 mm, 40°, sleeve, test chamber, phaco key, emergency key, giving set, display cover bag

Sterile/single use, box of 10  
VV660011D

---



---

## Example vitrectomy OR pack OS 4

Cassette, Caliburn trocar system, autoseal one step, continuous flow cutter, panorama light shielded, air with connector Air/BSS, giving set, display cover bag

Sterile/single use, box of 6  
VV660215BP

---



● 23 G

**Further phaco and vitrectomy packs are available on request. If you require any additional information, we will be happy to help.**

  Faros™/CataRhex 3®

---

**I/A cassette** 

including giving set and display cover bag

Sterile/single use, box of 10  
VV621010A

---



**Drainage bag for cassettes and tubing sets** 

Single use, box of 20  
VV636010

---



**Example phaco pack Faros/CataRhex 3** 

Tubing system, easyTip 2.2 mm, 40°, sleeve, test chamber, phaco key, emergency key, infusion set, drainage bag, protection bag

Sterile/single use, box of 10  
VV621011DE

---



**Example vitrectomy pack Faros**  ● 23 G

Tubing system, Caliburn trocar system one step, Continuous Flow Cutter, panorama illuminator shielded, giving set, PE bag for remote control, drainage bag, air delivery line, 3-way-stop-cock

Sterile/single use, box of 6  
VV621213BP

---

**Further phaco and vitrectomy packs are available on request. If you require any additional information, we will be happy to help.**

### Single-use products and reusable products



This symbol characterises products that have been designed for single use only. The products are marketed in a sterile state (EO sterilisation) and must not be reused.

Products without this symbol are suited for processing. Validated processing methods are described in the «Instructions of processing (cleaning, disinfection, sterilisation) for instruments» art. no. TN999042.

### Quality

All products meet the European legislation requirements for medical devices and have the CE marking (identification number 0297). The Quality Management System of Oertli has been certified according to the EN ISO standard 13485.

### Dimension standards

Oertli uses the following dimension standards (outside diameters):

- 20 G = 0.89 mm
- 23 G = 0.64 mm
- 25 G = 0.51 mm
- 27 G = 0.42 mm

### Information on trademark protection

Oertli®, CataRhex3®, easyPhaco®, easyTip®, abee® as well as the Oertli logo are registered trademarks of Oertli Instrumente AG.

Faros™, OS4™, HFDS™, FEELceps™, DirectAccess™, SPEEPMoDe™, Caliburn™, CortexMoDe™, ParaProg™, True Flow Control™ and GoodLight LED™ are trademarks of Oertli Instrumente AG.

MAKING THE  
DIFFERENCE  
IN SWITZERLAND





As a Swiss family-owned company with a long tradition, we focus on what is important: quality, reliability, safety, innovation and the needs of our customers.

We make the difference – for you and your patients.

**EYE SURGERY. SWISS MADE.**

Surgical  
platforms



OS 4™



Faros™



CataRhex 3®

**oertli**®  
S W I T Z E R L A N D

**Oertli Instrumente AG**  
Hafnerwisenstrasse 4  
9442 Berneck  
Switzerland

T +41 71 747 42 00  
F +41 71 747 42 90

[www.oertli-instruments.com](http://www.oertli-instruments.com)

Not available for sales in the US